

Easy Code Digital Lock

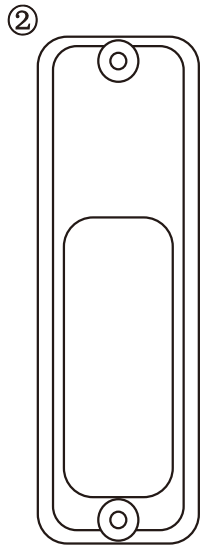
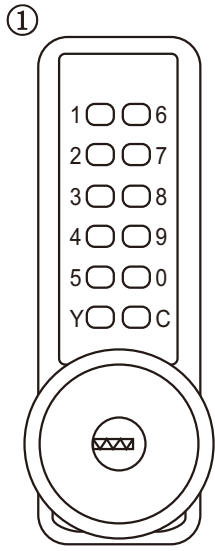

Parts List

Please make sure you have received all the following Parts:

- 1 Lock caes
- 2 Back Plate
- 3 Neoprene seals x2
- 4 Spindles
- 5 Latch(60mm Standard)
- 6 Striker Plate

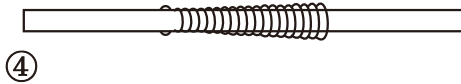

- 7 Wood screws x4.

Use with latch & strike plate.

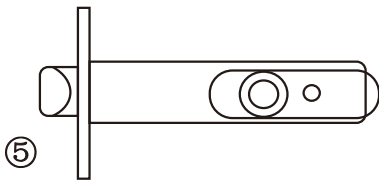

- 8 Latch support post

- 9 Fixing bolts,3 supplied(1 spare)

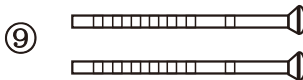
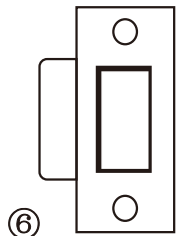

- 10 Each lock has three Keys

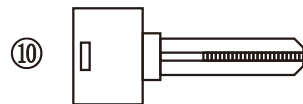

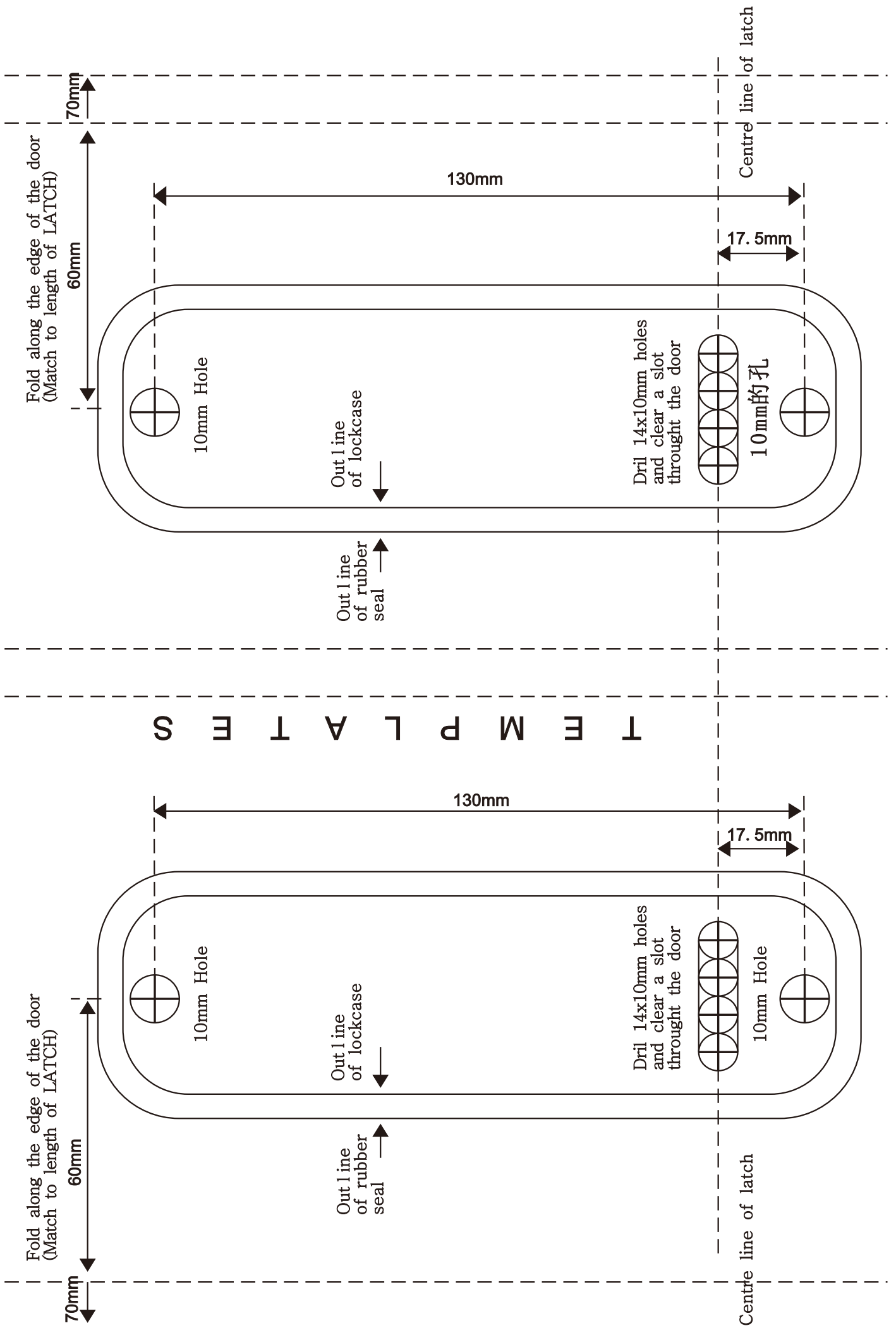

Fitting the strike plate

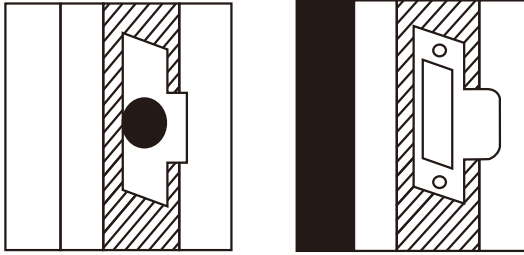

- Position the strike plate on the door so that it lines up with the flat of the latchbolt. **NOT THE PLUNGER.**
- Mark the inner and outer edges of the strike plate and cut a 1mm rebate so that it fits flush with the surface of the door frame.
- Drill or cut a recess for the latchbolt.
- Fit the strike plate using only one wood screw at first to ensure that it is positioned accurately. The latch bolt, and not the plunger, should enter the aperture easily, and be held without too much "play". When satisfied secure the strike with the second screw.

N.B. The plunger beside the latchbolt deadlocks the latchbolt and protects it against manipulation. IT MUST NOT enter the strike plate aperture when the door is closed

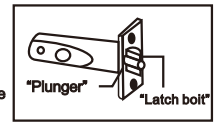

Removal of the Snib Function

"If the snib function is not required, you can remove it by unscrewing the 4 screws, one from each corner, (2 long & 2 short) from inside the backplate. This will enable the metal plate, the snib, a small spring & ball bearing to be removed. Please note that the metal plate, only Needs to be replaced plus the enclosed plastic clip to cover the aperture"

Changing the Entry Code

To change the code simple remove the lock from the door. On the reverse of the digital lock you will see screw button Which relate to the push buttons on the front of the lock.

To set about to operate within the code turn the screw relating to the button so that the dot is facing inward (towards the F) if you wish to take a button out of the code, Turn the screw so that the dot is facing outward (towards G)

Check the code on the lock to ensure the code works before re-fitting the lock and closing the door.

All code off

All code on

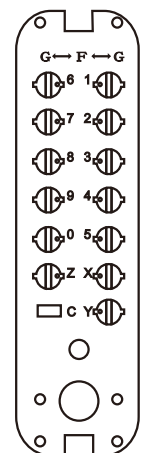
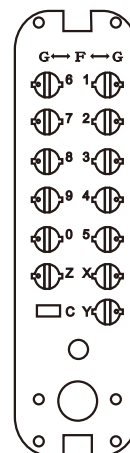

Special Notes

The 'Hold-open' model is equipped with a snib on the backplate. This enables the latchbolt to be held open when required.

Before commencing installation check that all parts are working correctly: Press the code according to the code card and then the knob should turn and return easily under spring pressure, if you intend to change the code, you should do it before installing the lock, See the code change instructions.

Make sure that the lever handle of the backplate moves freely. Check that the snib will engage and hold the handle in the 'latch-open' position, if it is a model with latch stopper.

Check that the latch bolt moves freely by pressing at the end and also by turning the flat spindle in the latch cam.

Installation

Apply the template

1. Tape the template to the door. Make sure that you fold it along the appropriate line, depending on the backset of the latch (60mm).
2. Mark and drill six 10mm holes.
3. Use a chisel to clear the line of 4 x 10mm holes into a single slot.
4. Mark a central point on the "centre line of latch" on the door edge.
5. Drill a 25mm hole x 85mm deep.
6. Insert the latch into the hole, and draw around the face plate.
7. Remove the latch and cut a 3mm rebate so that the face plate will fit flush with the door.
8. Secure the latch with the wood screws.

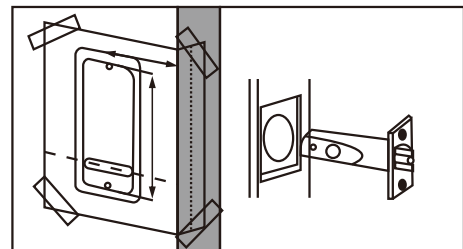

Positioning the Spindle

1. Select the spindle to suit the thickness of the door.
2. Insert the spindle through the slot in the door and make
3. Sure that it engages the latch correctly for the hand of
4. the door (see inset diagram).

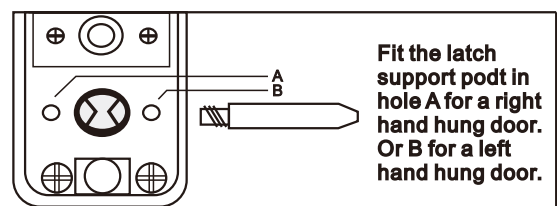

Fixing the Lock

1. Cut the fixing bolts to suit the door thickness, allowing at least one threaded section to screw into the lockcase
2. Hold the lock case and the backplate, with the seals, onto the door with the spindle in position.
3. Using the fixing bolts screw everything together through the top and bottom holes of the backplate.
4. Before final tightening make sure the lock is vertical, and test the mechanism to ensure that it is all moving easily.

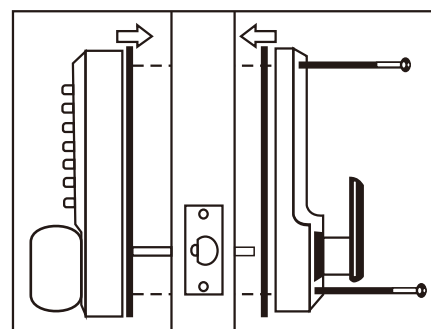

DO NOT CLOSE THE DOOR UNTIL YOU ARE SURE THAT THE CODE WORKS
DO NOT over tighten the fixing bolts as this may cause distortion and lead to poor operation.