



European Type Electromechanical Lock with Cylinder



YLI ELECTRONIC

Model:YML-650B

Parameters

Factory default	NO ; NC(Adjustable)
NO ;NC	NC: when door is closed, power on to lock, power off to unlock,cylinder is invalid to unlock in this status NO: power off to lock, power on to unlock or unlock by cylinder
Face Plate	275Lx25Wx51.9H(mm)
Strike	Standard Strike Plate: 150Lx30Wx1.5H(mm); Optional Strike Plate(for single swing door):150Lx48.7Wx1.5H(mm); Optional Strike Plate(for double swing door):150Lx67.5Wx1.5H(mm)
Magnetic Valve	500000 times
Voltage	12~24VDC/AC
Current	≤300mA
Signal Output	Lock signal NC/COM/NO contact, the signal will take effect only when both conditions of closing and locking are met
Operating temp	(-20℃~+50℃)
Weight	1.4kg

Standard Features

- | | |
|---|---|
| 1 Suitable for single or double swing doors | 5 Vertical or horizontal installation |
| 2 Suitable for narrow-frame wooden doors and metal doors | 6 304 stainless steel strike plate optional for single or double swing doors |
| 3 Fail safe and fail secure mode adjustable | 7 With lock signal output |
| 4 304 stainless steel panel, stainless steel bolt withstands 1000lbs holding force | 8 Electric/Automatical; Locking mode selectable |

Dimensions (Unit:mm)

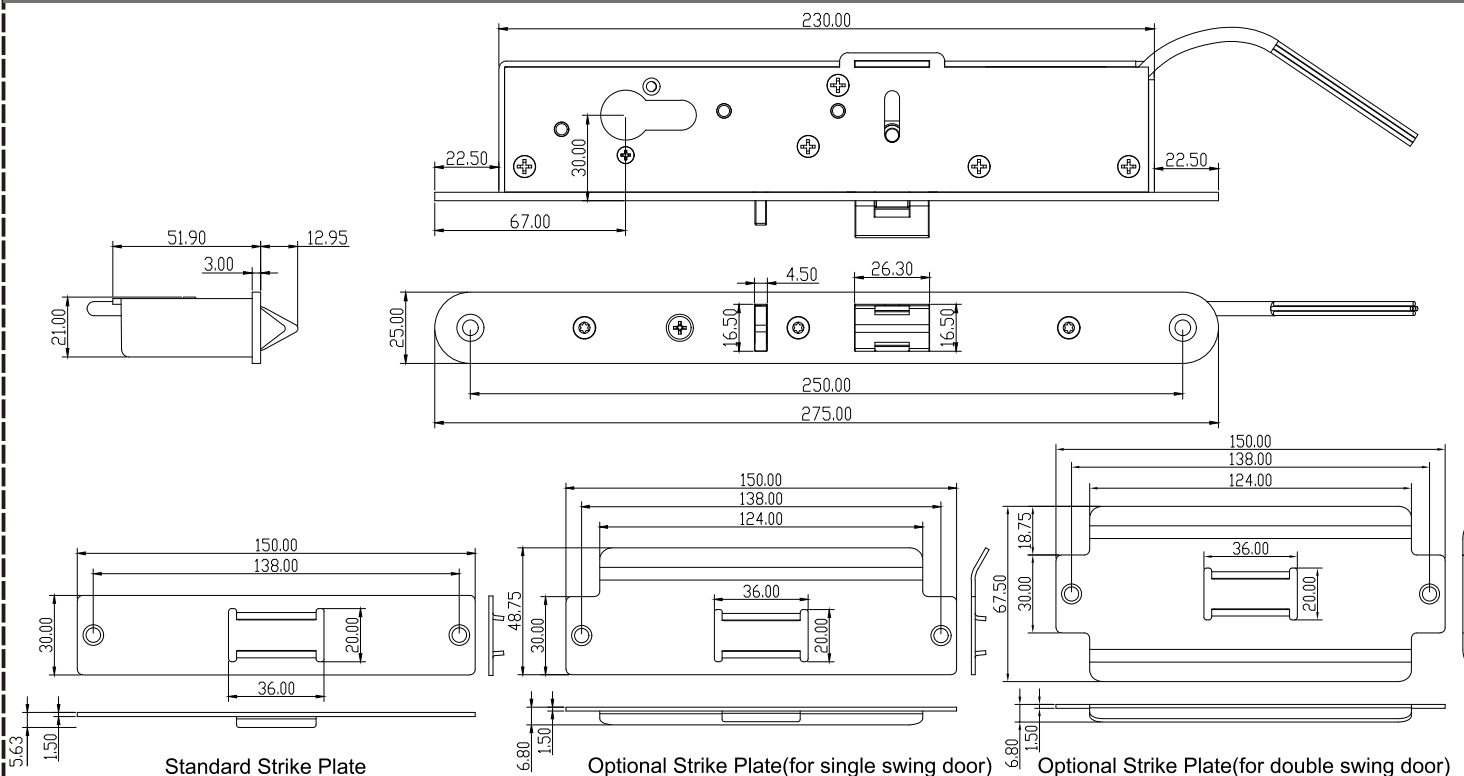

Installation

Fail Safe
Cylinder as shown below

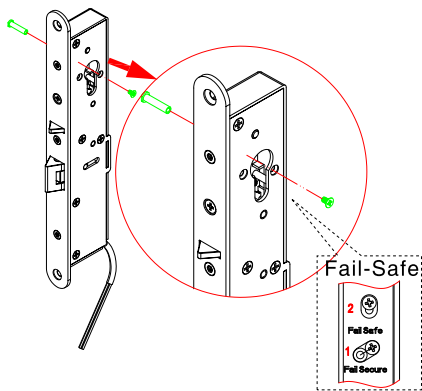

Fail secure
Cylinder as shown below

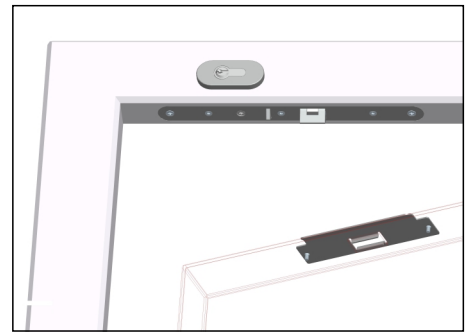
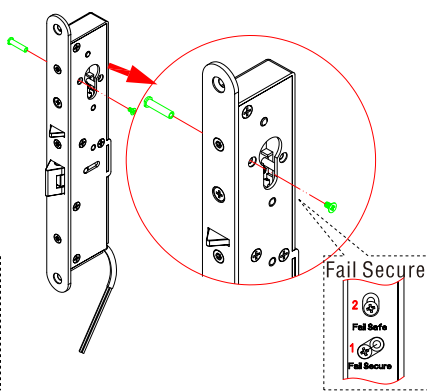

Installation on top

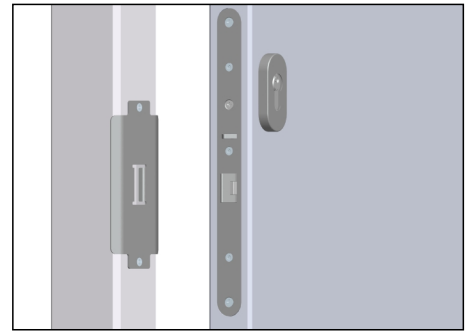

Side installation

Mode Switching

Pic 2: Unscrew 1 while loosen 2; Pic 3: sliding move screw 2
Pic: Tighten screw 1, 2, process finished

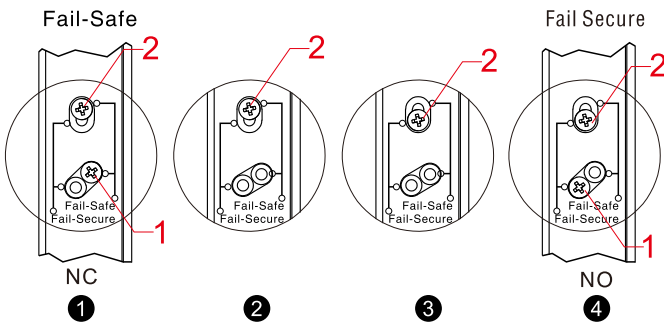

Tips:

Please loosen Screw 2 and move it slightly, do not take it out, or else it will make magnetic valve drop out of lock body.

Please follow steps on sticker while installing.

Wiring

	Red		+	
	Black		-	
	Yellow		NC	} Lock Signal Output
	White		COM	
	Green		NO	

Wiring Diagram

